

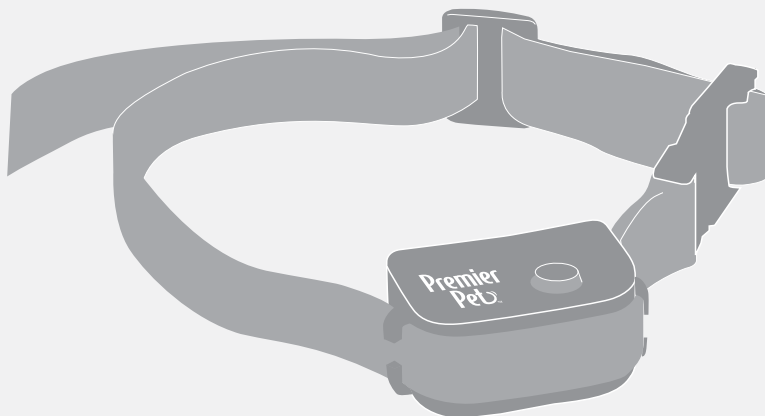

Spray Bark Collar

GBC00-16997 | Product Manual



Have questions about your Spray Bark Collar or
need training tips for your pet?

Our Customer Care representatives are here to help you.

Call our USA-based Customer Care Center at

+1 (866) 381-2785

USA & Canada: Mon-Fri 8am-8pm EST | Sat 9am-5pm EST

This product includes a one year warranty.

Call, click, or chat with us before you return your product.

premierpet.com

IMPORTANT SAFETY INFORMATION

Explanation of Attention Words and Symbols used in this Product Manual



This is the safety alert symbol. It is used to alert you to potential personal injury hazards. Obey all safety messages that follow this symbol to avoid possible injury or death.

WARNING

WARNING indicates a hazardous situation which, if not avoided, could result in death or serious injury.

CAUTION

CAUTION, used with the safety alert symbol, indicates a hazardous situation which, if not avoided, could result in minor or moderate injury.

CAUTION

CAUTION, used without the safety alert symbol, indicates a hazardous situation which, if not avoided, could result in harm to your pet.

WARNING

Not for use with aggressive dogs. Do not use this product if your dog is aggressive, or if your dog is prone to aggressive behavior. Aggressive dogs can cause severe injury and even death to their owner and others. If you are unsure whether this product is appropriate for your dog, please consult your veterinarian or certified trainer.

Lithium Rechargeable Batteries- This device contains Lithium-Ion (Li-Ion) batteries; never incinerate, puncture, deform, short-circuit, or charge with an inappropriate charger. Fire, explosion, property damage, or bodily harm may occur if this warning is not followed.

CONTENTS UNDER PRESSURE. CONTAINER MAY EXPLODE IF HEATED.

- Do not puncture or incinerate the collar or the refill cartridge.
- Do not expose the device to freezing temperatures (-32 °F or 0 °C) or to conditions warmer than 113 °F or 45 °C.
- Do not leave the collar in direct sunlight.
- Never leave the collar in a car where the device can heat up to high temperatures (113 °F or 45°C).
- Store in a well-ventilated place.
- KEEP OUT OF REACH OF CHILDREN.

First Aid and Treatment:

If inhaled, get medical attention if you feel unwell. After skin contact, rinse the affected area with soap and water. After eye contact, rinse/flush eyes gently using water for 15–20 minutes.

⚠ CAUTION

This product is not a toy. Keep it away from the reach of children. Use it only for its bark stopping purpose.

CAUTION

Risk of skin damage. Please read and follow the instructions in this manual. Proper fit of the collar is important. A collar worn for too long or made too tight on the pet's neck may cause skin damage. Ranging from redness to pressure ulcers; this condition is commonly known as bed sores.

- Avoid leaving the collar on the dog for more than 12 hours per day.
- When possible, reposition the collar on the pet's neck every 1 to 2 hours.
- Check the fit to prevent excessive pressure; follow the instructions in this manual.
- Never connect a leash to the electronic collar.
- When using a separate collar for a leash, don't put pressure on the electronic collar.
- Wash the dog's neck area and the contact area of the collar weekly with a damp cloth.
- Examine the contact area daily for signs of a rash or a sore.
- If a rash or sore is found, discontinue use of the collar until the skin has healed.
- If the condition persists beyond 48 hours, see your veterinarian.

The Premier Pet™ Spray Bark Collar must be used only on healthy dogs. We recommend that you take your dog to a veterinarian before using the collar if he is not in good health.

What's Included

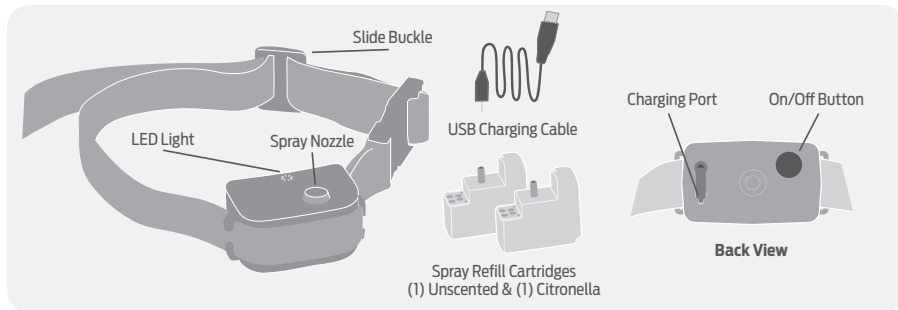

How it Works

The Premier Pet™ Spray Bark Collar effectively deters barking when it is worn. The Spray Bark Collar has a unique sensor that provides the most reliable bark detection available. This ensures no other noises besides your dog barking will activate the collar. The collar works with unscented or citronella spray. Both spray options are safe and will distract your dog and interrupt the unwanted behavior. As an added safety feature, the Spray Bark Collar will automatically shut off for 3 minutes if your dog barks 15 times or more within a 80-second period.

Getting Started

Fit the Collar

Important: The proper fit and placement of the Spray Bark Collar is important for effective operation. The contact point must have direct contact with your dog's skin on the underside of his neck.

1. Make sure that the collar is turned off. The LED should not blink (refer to Collar On/Off section on page 6).
2. Start with your dog standing comfortably. Place the collar on your pet so that the Premier Pet™ logo is right side up. Direct the Spray Nozzle toward the dog's snout. **(A)**.
3. Check the tightness of the collar by inserting one finger between the end of a contact point and your dog's neck **(B)**. The fit should be snug but not constricting.
4. Allow your dog to wear the collar for several minutes, and then recheck the fit. Check the fit again as your dog becomes more comfortable with the collar.

NOTE: For long-haired dogs, it may be necessary to trim the neck hairs along the path of the spray. It is important that the spray reaches the dog's snout to be effective.

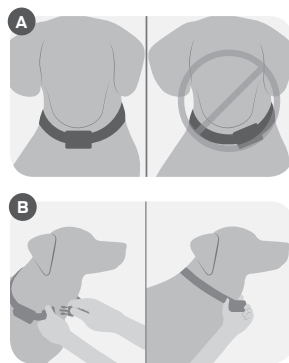

Add the Refill Cartridge

1. Ensure the collar is off (A).
2. The refill cartridge is located on the bottom of the collar.
3. Press and slide the button and the refill cartridge door will open (B).
4. Remove the shipping cap from the refill cartridge before inserting into the collar (C-D).
5. Close the refill cartridge door.

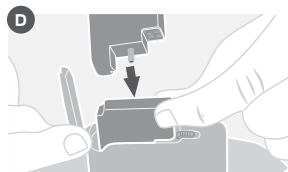
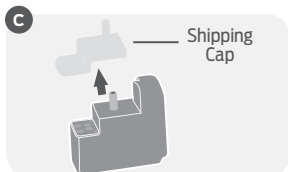
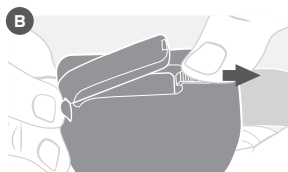
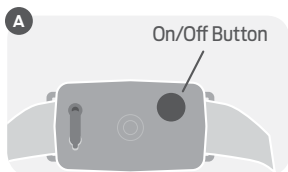

If the spray bark collar is

turned on and there is no spray refill cartridge in the collar, the red and yellow LED's will flash for 5 seconds and the collar will turn off.

NOTE: To reorder refill cartridges, visit premierpet.com to locate a retailer near you.

⚠ WARNING

Do not expose the device to freezing temperatures (-32° F or 0° C) or to conditions warmer than 113° F or 45° C. Do not leave the collar in direct sunlight. Never leave the collar in a car where the device can heat up to high temperatures (113° F or 45° C).

⚠ CAUTION

CONTENTS UNDER PRESSURE. CONTAINER MAY EXPLODE IF HEATED. Do not expose to heat or store at temperatures above 113° F or 45° C. Do not puncture. Do not burn. Protect from sunlight. Store away from heat. Store in a well-ventilated place. This product is not a toy. KEEP OUT OF REACH OF CHILDREN. Use it only for its bark stopping purpose.

FIRST AID TREATMENT: If inhaled, get medical attention if you feel unwell. After skin contact, rinse affected area with soap and water. After eye contact, rinse/flush eyes gently using water for 15-20 minutes.

Ensure Proper Spray Pattern

For the Premier Pet™ Spray Bark Collar to perform properly, the nozzle must be positioned correctly and there must be a clear path from the Spray Nozzle to your dog's snout. Follow these steps:

1. Make sure the collar is upright and the Spray Nozzle is angled out and pointing up towards the dog's snout. For long-haired dogs, it may be necessary to trim the neck hairs along the path of the spray. It is important that the spray reaches the dog's snout to be effective.

NOTE: It is important the collar is fit properly for the Spray Bark Collar to be effective. Please refer to the Fit the Collar instructions.



CAUTION

Do not shave the pet's neck as this may increase the risk of skin irritation.

Charge the Collar

Excessive charging can shorten battery life. Only charge your collar when the batteries are low.

1. Plug in and fully charge the collar. This can take up to 6 hours.
2. When fully charged, the red LED on the collar will turn off. Replace the rubber cover after charging.

To Turn the Collar On

Press and hold the on/off button until the collar beeps once and then release. The red LED will flash 3 times. If refill cartridge is empty, the yellow LED will flash an additional 2 times.

To Turn the Collar Off

Press and hold the on/off button until the collar beeps once and then release. The red LED will flash 5 times and turn off.

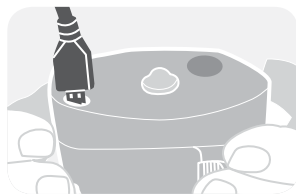

Battery Life

Average battery life is 2 months, depending on how often your dog barks. However, due to greater use during your dog's training, the battery life during the first week may not last as long.

Low Battery Indicator

During normal operation the red LED will flash 1 time every 5 seconds to indicate good battery, or 3 times every 5 seconds to indicate low battery.

Empty Spray Indicator

Yellow LED will flash 2 times every 5 seconds when the refill cartridge is empty and needs to be replaced.

LED	Function	Beep Response
Red LED flashes 3 times	Spray collar is turned on	1 Beep
Red LED flashes 5 times	Spray collar is turned off	1 Beep
Red LED flashes once every 5 seconds	Collar is on	none
Red LED flashes once every 3 seconds	Low battery	none
Yellow LED solid	Testing	1 Beep
Red and Yellow LED's alternate flashing for 5 seconds, the collar turns off	No spray cartridge	4 Beeps
Yellow LED flashes 2 times every 5 seconds	Spray cartridge is empty	none
Yellow LED flashes 2 times	Turning collar on when cartridge is empty	2 Beeps
Red LED Solid	Charging	2 Beeps

Test the Collar

1. Plug the charger into the Spray Bark Collar.
2. While the charger is plugged in, press and hold the on/off button.
3. Continue to hold the on/off button while unplugging the charger from the Spray Bark Collar. A yellow LED will appear.
4. Release the on/off button. After a 2 second delay, the following will begin: the Spray Bark Collar will beep then release spray. Then, it will sound the normal power off beep and turn itself off. Ensure the spray port is pointed away from your face.
5. The test can be stopped at any time by pressing the on/off button.

What to Expect

- The first few times your dog wears the Spray Bark Collar, do not leave him alone. Most dogs will understand very quickly and you will notice a reduction in barking within the first couple of days.
- Because the spray may be surprising at first, some dogs may bark more initially, but this will decrease.
- Although very rare, a dog may get into a bark-spray-bark cycle the first time he wears the collar. If this happens, reassure your dog with calm soothing tones. As your dog relaxes, he will understand that if he is quiet, he will not receive any more spray bursts.
- Dogs will sometimes “test” the collar during the training period, usually the second week. Stay consistent.
- Place the collar on your dog in every situation you want him to be quiet.

Tips & Maintenance

- Clean your dog’s hair weekly with a washcloth and a mild hand soap. Rinse and dry your dog’s neck thoroughly.
- Wipe the Spray Bark Collar clean with a damp cloth and dry thoroughly once a month or as needed.
- You may go through more spray during the training period.
- Do not leave your collar unattended where your dog could accidentally damage it.

To Re-Thread the Collar

- The slide buckle prevents the collar from becoming loose around your pet’s neck.
- The ridges must be facing up; the collar will slip if it is not properly threaded.

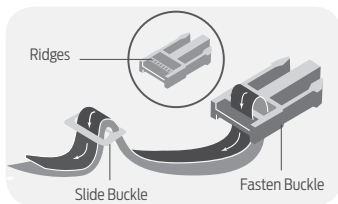

Terms of Use and Limitation of Liability

1. Terms of Use

The use of this product is subject to your acceptance without modification of the terms, conditions and notices contained with this product. Use of this product implies acceptance of all such terms, conditions, and notices. If you do not wish to accept these terms, conditions, and notices, please return the product, unused, in its original packaging and at your own cost and risk to the relevant Customer Care location together with proof of purchase for a full refund.

2. Proper Use

Proper Use includes, without limitation, reviewing the entire Product Manual and any specific safety information statements. The specific temperament or size/weight of your pet may not be suitable for this product. If you are unsure whether this product is appropriate for your pet, please consult your veterinarian or certified trainer prior to use. For products used with pets where training is desired, Radio Systems Corporation recommends that these training products are not used if your pet is aggressive and accepts no liability for determining suitability in individual cases.

3. **No Unlawful or Prohibited Use**

This product is designed for use with pets only. This product is not intended to harm, injure or provoke. Using this product in a way that is not intended could result in violation of Federal, State or local laws.

4. **Limitation of Liability**

In no event shall Radio Systems Corporation or any of its associated companies be liable for (i) any direct, indirect, punitive, incidental, special or consequential damage and/or (ii) any loss or damages whatsoever arising out of or connected with the use or misuse of this product. The Purchaser assumes all risks and liability from the use of this product to the fullest extent permissible by law.

5. **Modification of Terms and Conditions**

Radio Systems Corporation reserves the right to change the terms, conditions and notices governing this product from time to time. If such changes have been notified to you prior to your use of this product, they shall be binding on you as if incorporated herein.

Warranty

One Year Non-Transferable Limited Warranty

This product has the benefit of a limited manufacturer's warranty. Complete details of the warranty applicable to this product and its terms can be found at www.premierpet.com

Compliance

FCC

This device complies with part 15 of the FCC Rules. Operation is subject to the following two conditions: (1) This device may not cause harmful interference, and (2) this device must accept any interference received, including interference that may cause undesired operation.

NOTE: This equipment has been tested and found to comply with the limits for a Class B digital device, pursuant to part 15 of the FCC Rules. These limits are designed to provide reasonable protection against harmful interference in a residential installation. This equipment generates, uses, and can radiate radio frequency energy and, if not installed and used in accordance with the instructions, may cause harmful interference to radio communications. However, there is no guarantee that interference will not occur in a specific installation. If interference does occur to radio or television reception, which can be determined by turning the equipment off and on, the user is encouraged to try to correct the interference by one or more of the following measures:

- Reorient or relocate the receiving antenna.
- Increase the separation between the equipment and the receiver.
- Connect the equipment to an outlet on a circuit different from that to which the receiver is connected.
- Consult customer care, the dealer, or an experienced radio/TV technician for help.

CAUTION: Modification or changes to this equipment not expressly approved by Radio Systems Corporation may void the user's authority to operate the equipment.



Important Recycling Advice

Please respect the Waste Electrical and Electronic Equipment regulations in your country. This equipment must be recycled. At the end of the product life, do not place it in the normal municipal waste system. Please check the regulations in your area or return it to where it was purchased so that it can be placed in our recycling system. If these options are not possible, please contact the Customer Care Center for further information.